

Seat Base Swivel Troubleshooting Guide (All models)



Issue: Swivel tight to turn once installed into vehicle.

Cause: If the swivel is hard to turn once installed into the vehicle, it is most likely because the 6 main **M10 centre bolts** that hold the swivel together (**Fig. 1 & Fig. 2**) have been overtightened during the initial assembly or installation processes.

Solution: Loosen the **6 x M10 bolts/nyloc nuts**, ensure the swivel turns freely, then retighten them to **4.4Nm**. If a torque wrench isn't available, tighten the **nyloc nuts** just enough until all **12 washers** (6 x top and 6 x bottom) don't have any movement.

Note: *The seat may need to be removed from the swivel to allow access to the bolts/nuts.*

The swivel should now operate as expected.

Figure 1
Swivel Top View

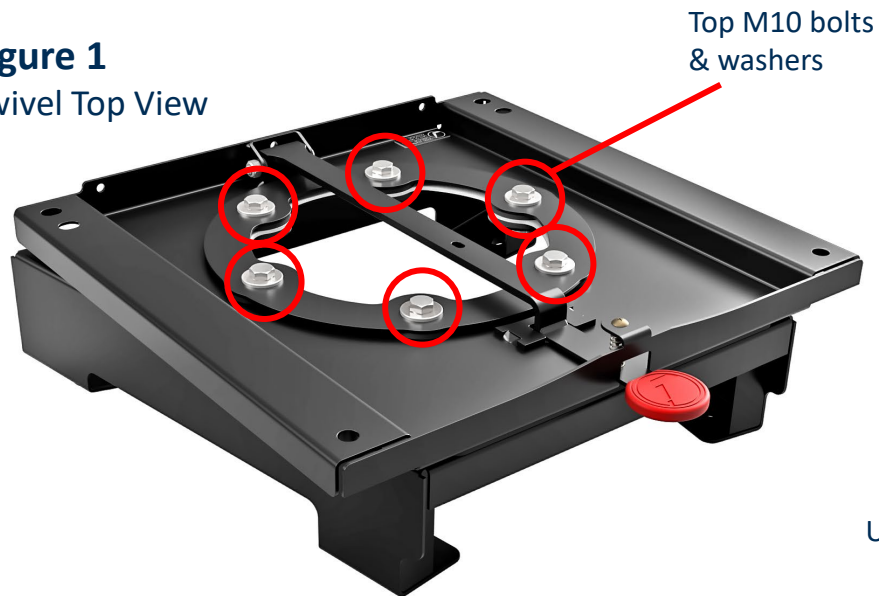
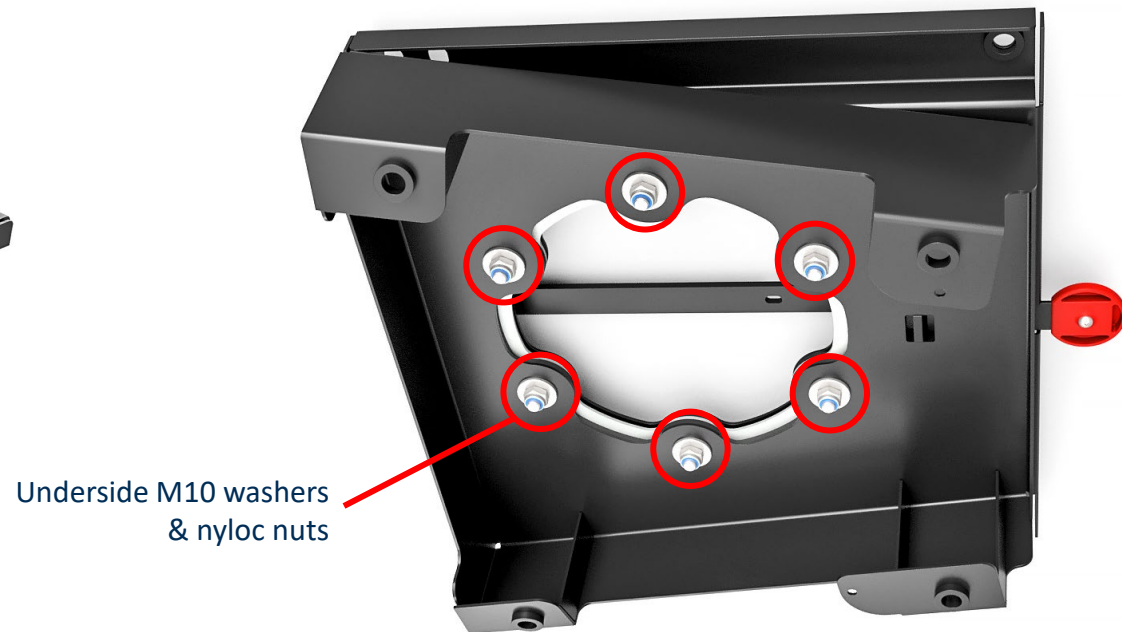

Figure 2
Swivel Underside View



*H300 swivel shown