

ITEM NO.	PART NO.	QTY.	DESCRIPTION	PACKED BY
1	TSA1126	1	FRONT CENTRE SEAT ASSEMBLY	
2	TS1114-11	1	DASHBOARD TRIM PANEL	
3	TS1114-12	1	HANDBRAKE SHROUD	
4	10X75M 88 ZPB	2	M10 x 75mm HEX HEAD BOLT	
5	10X65M 88 ZPSS	2	M10 x 65mm HEX HEAD SET SCREW	
6	10M SW	4	M10 SPRING WASHER	
7	10M ZPW	4	M10 FLAT WASHER	
8	TS917	2	SPACER Ø26.7 x 33mm	
9	TS1019	2	SPACER Ø26.7 x 23mm	
10	23 WB 1016	9	#10 X 16mm PHILLIPS SCREW	
11	TS371-S	1	M10 UNDERFLOOR PLATE 70 x 40	
12	TS371	3	M10 UNDERFLOOR PLATE 95 x 40	
13	B-138	1	SQUARE FLOOR INFILL 1	
14	B-139	1	SQUARE FLOOR INFILL 2	
15	B-165	1	ROUND FLOOR INFILL 3	
16	B-166	1	ROUND FLOOR INFILL 4	
17	TS1114-10	1	REAR COVER PLATE	
18	-	1	FITTING INSTRUCTIONS - WITHIN THIS PACKING KIT	

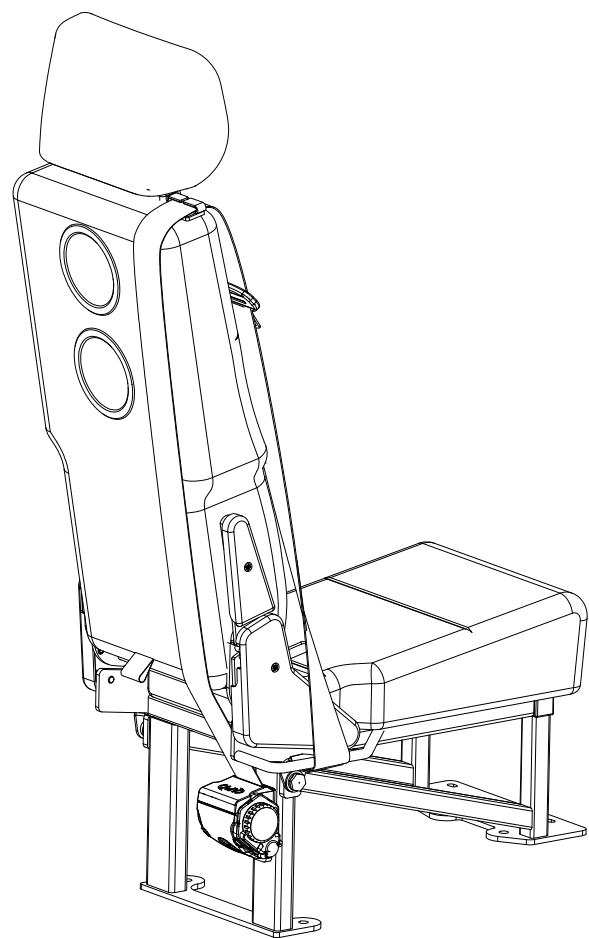
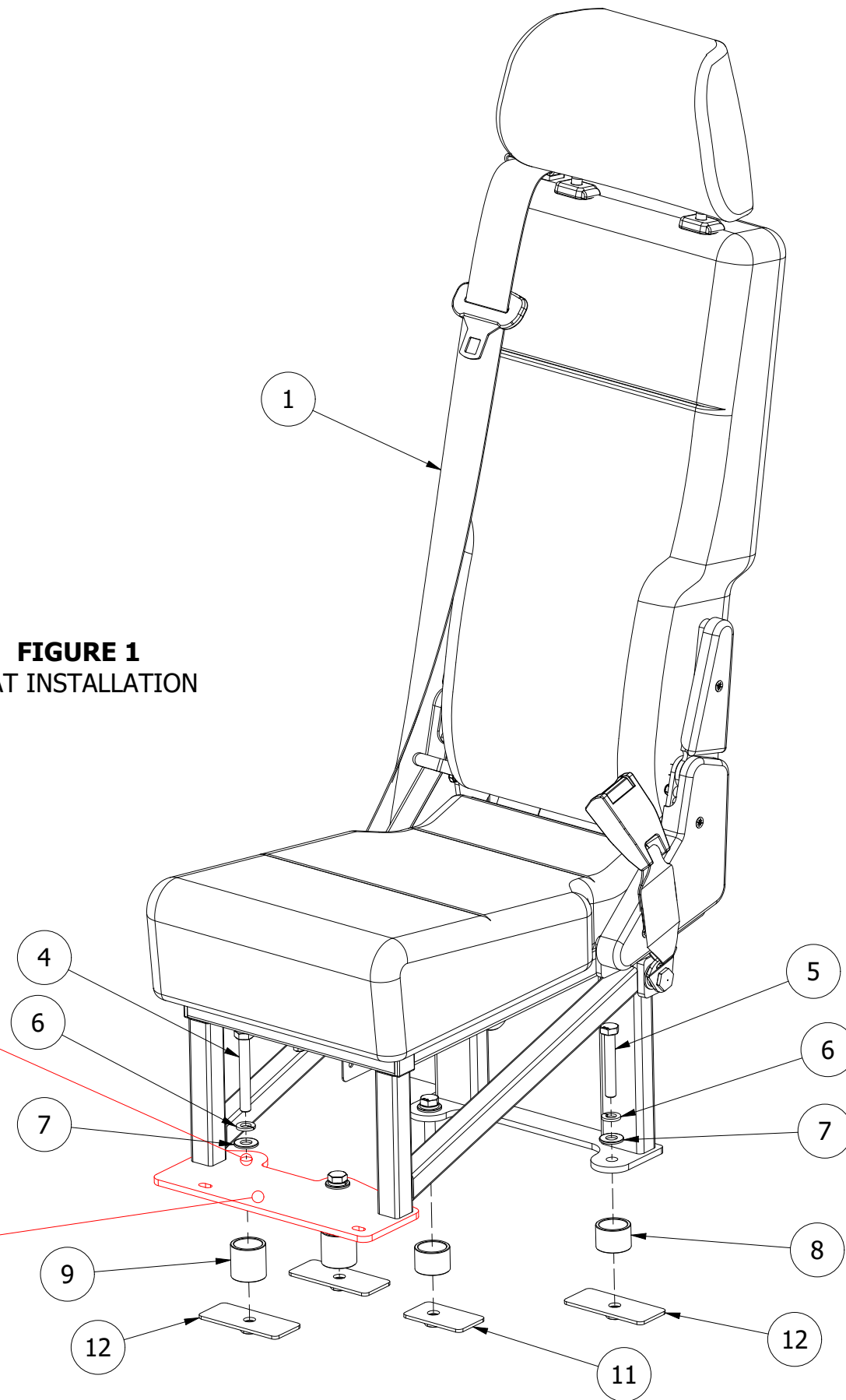

FIGURE 1
SEAT INSTALLATION



NOTE: Electrical wires in close proximity to driver side front mount hole.
Move wires aside before drilling through floor foam with hole saw.

NOTE: Ensure that fuel door release cable/mechanism is not pinched under front floor plate of seat during install.

IMPORTANT INFORMATION FOR INSTALLERS

Aftermarket seats and swivels sold by Techsafe Seating have been tested by an approved testing authority in Australia and found to meet the strength and performance requirements of the appropriate standards. Aftermarket seats and swivels should only be installed by competent and experienced personnel. Aftermarket seats and swivels in some state jurisdictions may require certification by a qualified certifying engineer. In all instances professional engineering advice should be sought to ensure the suitability of the integration of the seat or swivel into the original vehicle structure and to consider for any effect the modification may have on that vehicles compliance with legislated standards. As the manufacturer and seller of this product has no control over the end use or the fitment to the vehicle, the manufacturer and seller accepts no responsibility or liability for any malfunction of the product or the vehicle occupant safety systems as a direct or indirect result of faulty installation or unauthorized repair or modification to this product. Modification of the seat, swivel or installation kit should not be made without certification by a qualified engineer or manufacturers written consent. Where components of the installation kit are modified to better suit the specific nature of the installation, these must be substituted with components of equivalent or greater strength. Good engineering practice should be evident at all times including the use of metal spacers between brackets and the floor pan, appropriately torqued anchorage bolts, rust inhibitors on drilled holes and adhesive sealant used on underfloor backing plates.

PROPRIETARY AND CONFIDENTIAL

THE INFORMATION CONTAINED IN THIS DRAWING IS THE SOLE PROPERTY OF TECHSAFE. ANY REPRODUCTION IN PART OR AS A WHOLE WITHOUT THE WRITTEN PERMISSION OF TECHSAFE IS PROHIBITED.



56 Lower Mountain Road
HERVEY BAY QLD 4655
PH 07 4128 3337
email: technical@techsafeseating.com.au
web: techsafeseating.com.au

PRODUCT FRONT CENTRE SEAT

VEHICLE/PROJECT
TOYOTA HIACE H300 VAN 05/2019 ON
(VARIANTS WITH CENTRE CONSOLE)

DESIGN APPROVAL No. LK2 1093165	COMPLIES WITH VSB 5 (3 - Rev. 1) CAT 1	REV 2
DATE 1/12/2022	DWG No. PK163	

FITTING INSTRUCTIONS

STEP 1 - CENTRE CONSOLE REMOVAL & SEAT FITMENT

Remove the centre console from the vehicle. Leave the hand brake cover/surround in position. Next, position the front centre seat into the vehicle.

Insert 2 of the M6x52mm bolts (removed from OEM centre console) into the 2 slotted holes in the front floor plate (as per **Figure 2**). The bolts are to thread into the OEM points in the vehicle floor that the centre console bolts were removed from.

Use a 27mm hole saw to drill through the floor foam covering to allow for fitment of the 4 spacer tubes. **NOTE: See Pg.1 warning regarding electrical wires under floor foam!**

Next, drill the 4 bolt holes out to approx. 10.5mm to allow for fitment of the M10 bolts.

Fit the M10x65mm and M10x75mm bolts, washers and underfloor plates as per **Figure 1** on **page 1**.

Once all bolts, washers and underfloor plates are fitted and aligned correctly, tighten all M10 bolts to **32ft.lb / 44Nm**.

NOTE: The OEM centre console bolts that were used to position the seat can be removed once seat is bolted down and complete.

FIGURE 2
SEAT POSITIONING

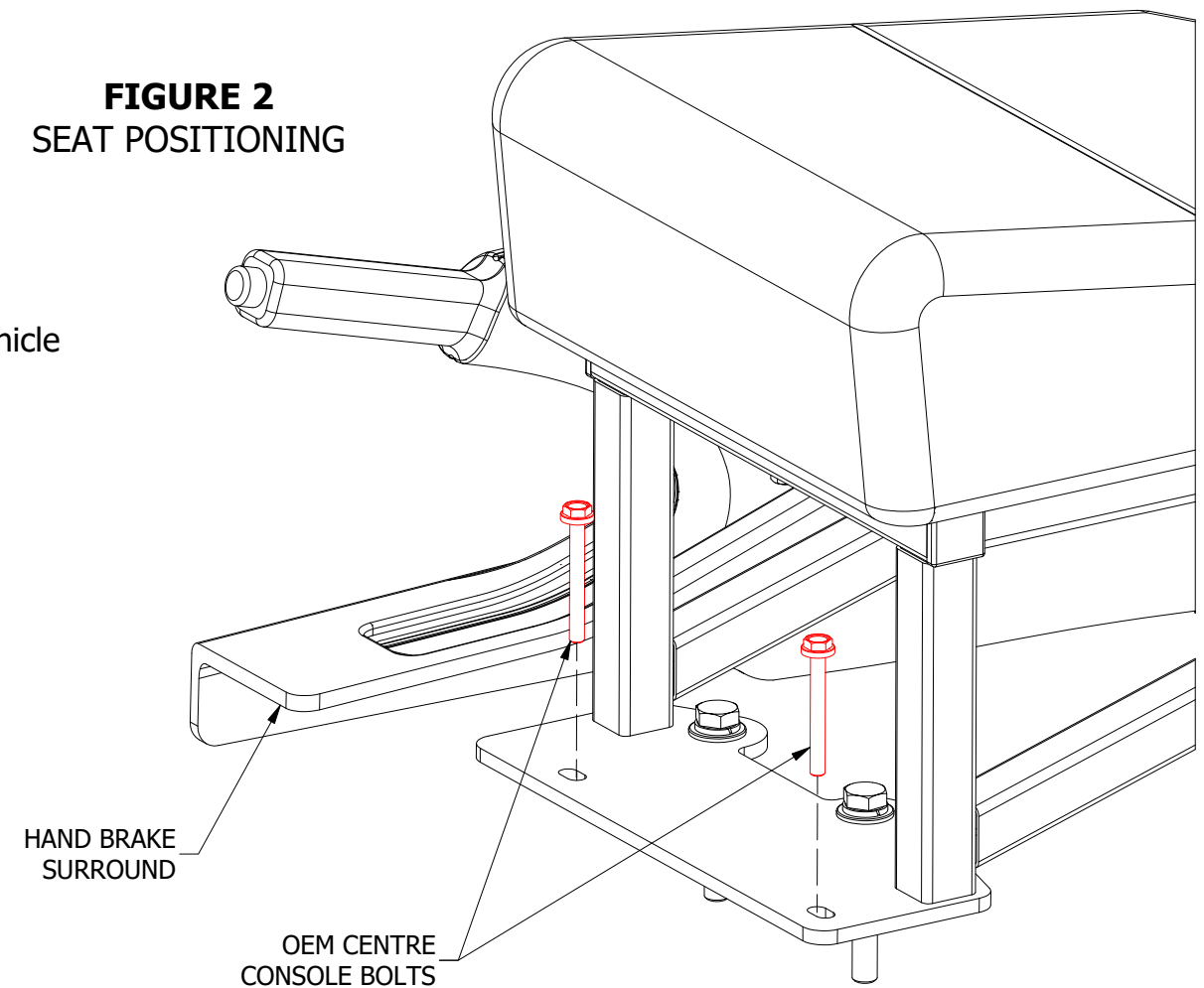
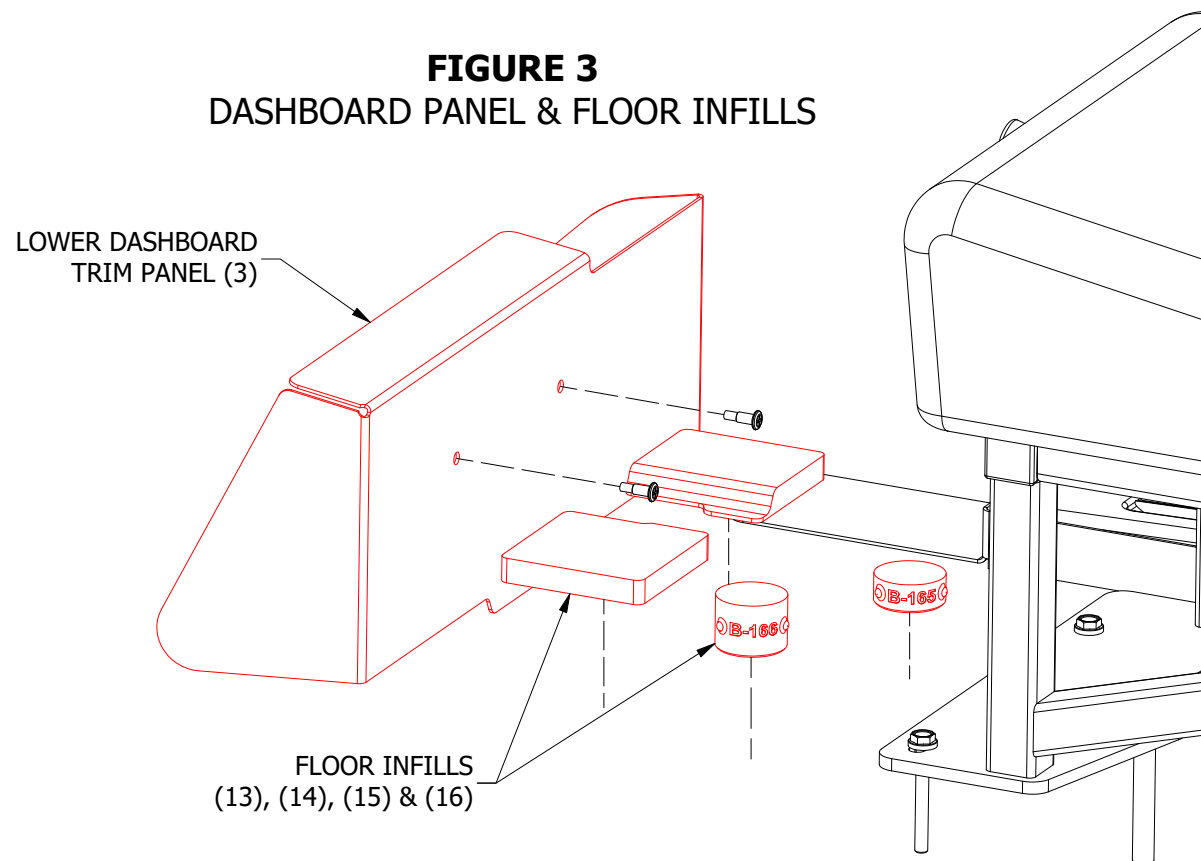

FIGURE 3
DASHBOARD PANEL & FLOOR INFILLS



STEP 2 - DASHBOARD COVER PANEL & FLOOR INFILLS

As shown in **Figure 3**, fit the 4 floor infill parts into the open floor cavities left from the centre console removal. **NOTE: These infill boards can be glued in if desired.**

Next, align the front lower dashboard trim panel and secure using 2 of the supplied #10 x 16mm screws. **Do not over tighten the screws**, as they thread into soft plastic.

STEP 3 - HAND BRAKE SHROUD

Next, the hand brake front shroud can be fitted.

The hand brake shroud has 2 locating tabs (one on either side), which lock into the OEM hand brake surround.

A #10 x 16mm screw is to be fitted to the passenger side tab, to lock the hand brake shroud into position (as per **Figure 4**).

The front tab on the hand brake shroud covers the large recess left in the floor from removing the OEM centre console.

NOTE: This tab can be glued to floor if required.

FIGURE 4
HAND BRAKE SHROUD

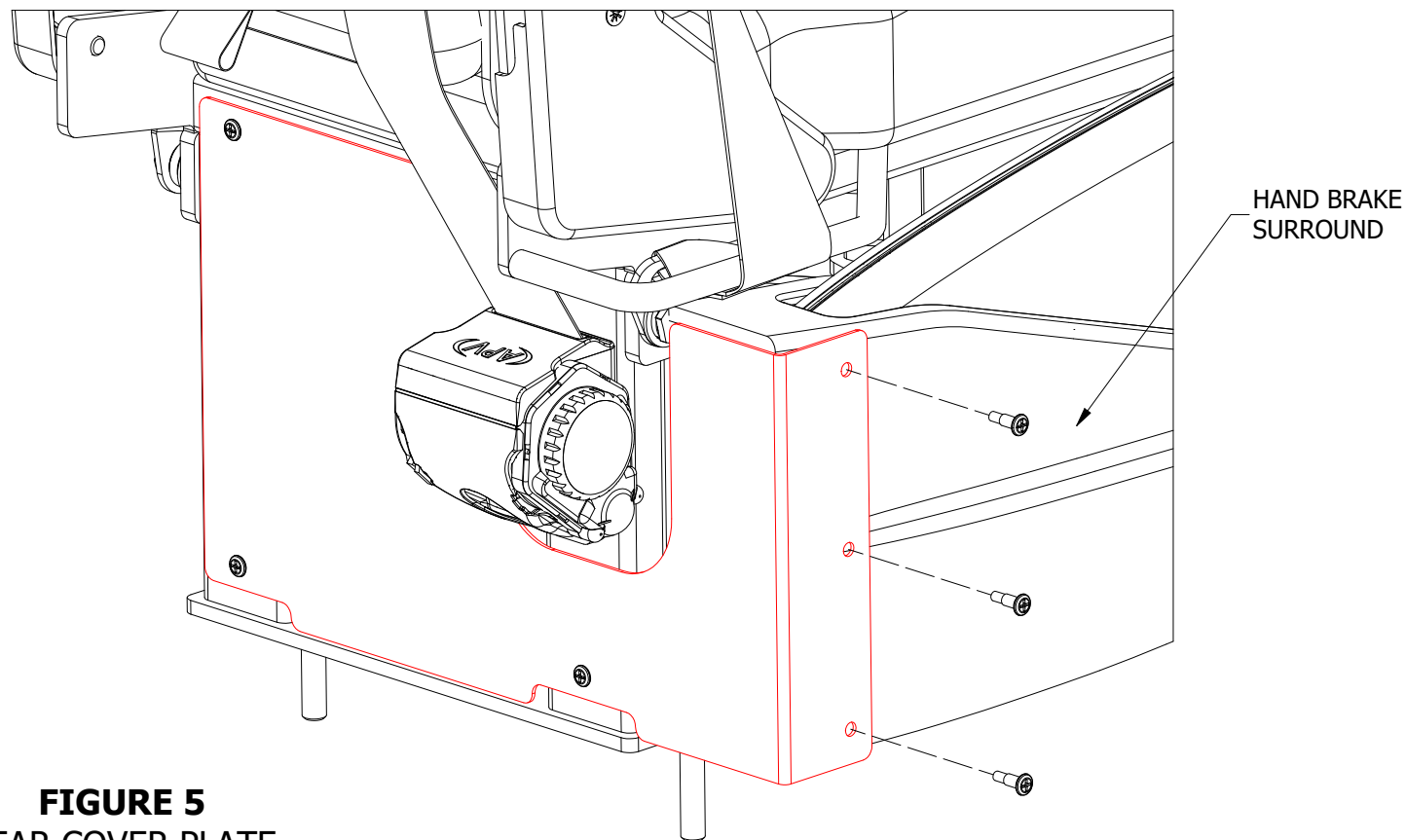
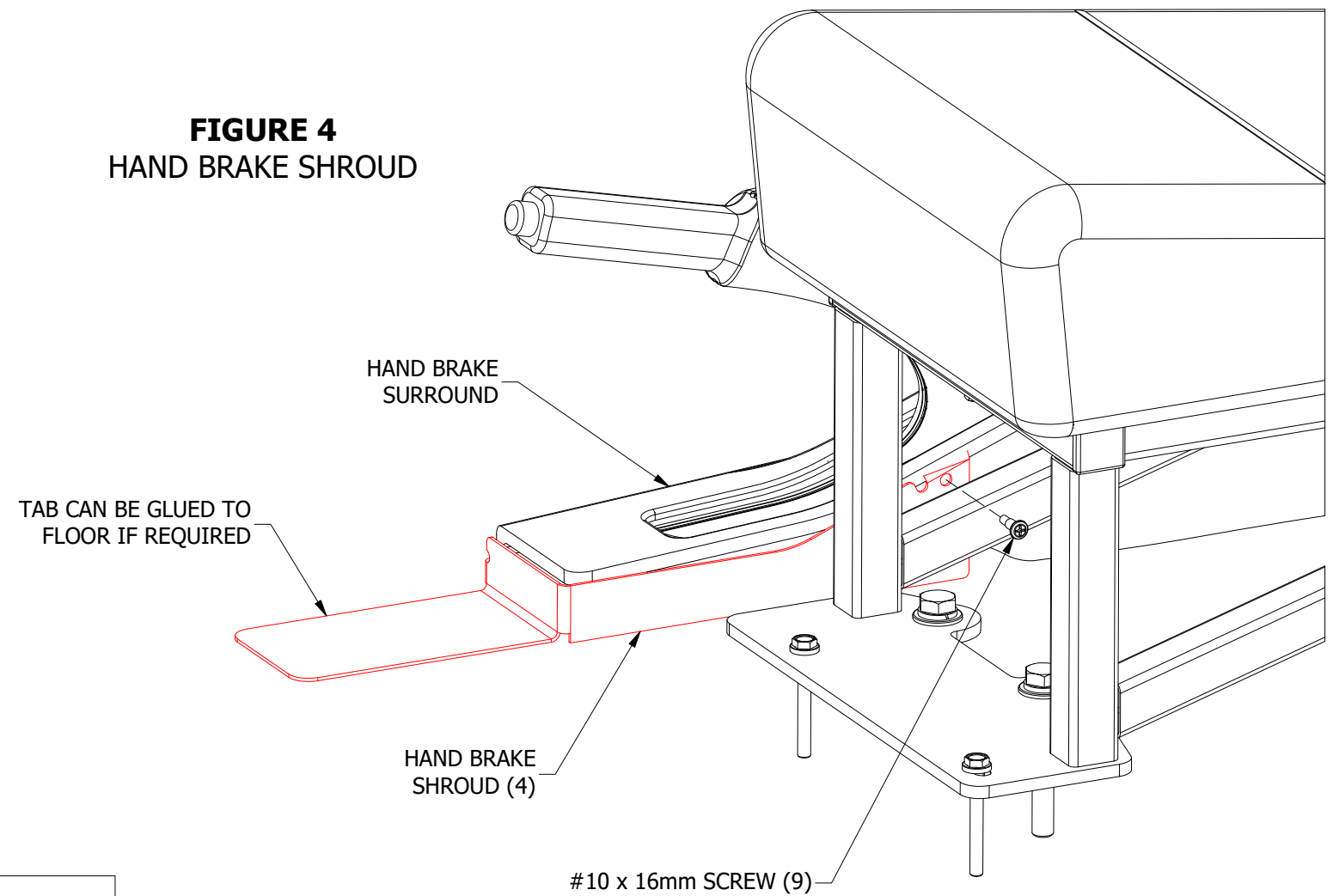

FIGURE 5
REAR COVER PLATE

STEP 4 - REAR COVER PLATE

Next, the rear cover plate (2) can be attached as shown in **Figure 5**.

Using 3 #10 x 16mm screws attach the rear cover plate to the hand brake surround, taking care not to over tighten them.

FIGURE 6
PASSENGER SEAT RAIL TAB

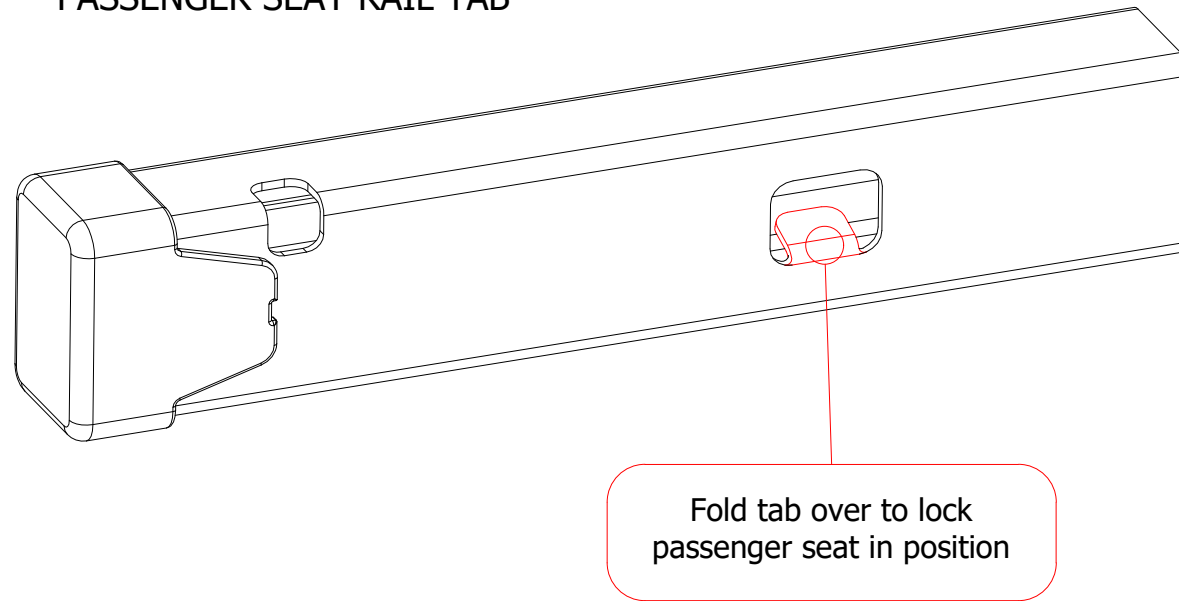

STEP 5 - PASSENGER SEAT RAIL TAB

In order for the subject seat to be compliant with the dimensional requirements of ADR 5/06 and VSB 5, the 1st row passenger seat must be permanently locked into its rear-most position such that the combination of the centre seat and OEM 1st row passenger seat create a 2-occupant bench seat arrangement, with a combined cushion width of 820mm.

The 1st row passenger seat should be permanently locked into its rear-most position by folding in the metal tab on outboard seat slide rail, as shown in **Figure 6**.

IMPORTANT NOTE: ANCAP SAFETY RATING

It should be noted that any modifications to a vehicle, including the fitment of additional equipment or seating within a vehicle cabin, has the potential to affect any ANCAP safety rating, or similar, that has been claimed by a vehicle manufacturer. This rating is purely for consumer information and allows for comparison of vehicle safety performance under prescribed test conditions. It is not a mandatory safety standard required for homologation and supply to market. Vehicle owners and operators will need to make their own assessment in this regard with respect to their fleet safety requirements.

