

ITEM NO.	PART NO.	QTY.	DESCRIPTION	PACKED BY
1	TSA1137	1	TRIPLE REVERSE FACING FLIP-UP SEAT ASSEMBLY	
2	TS1133	1	CRASH FRAME SUPPORT BEAM - PASSENGER SIDE	
3	TS1134	1	CRASH FRAME SUPPORT BEAM - DRIVER SIDE	
4	TS1132-02	4	SPACER Ø26.9 x 40mm	
5	TS1132-04	2	BACKING PLATE WELDMENT	
6	10X90M 88 ZPSS	1	M10 x 90mm HEX HEAD SET SCREW	
7	10X70M 88 ZPSS	4	M10 x 70mm HEX HEAD SET SCREW	
8	10X50M 88 ZPSS	4	M10 x 50mm HEX HEAD SET SCREW	
9	10M SW	8	M10 SPRING WASHER	
10	10M ZPW	10	M10 FLAT WASHER	
11	10M NYLN	1	M10 NYLOC NUT	
12	8X20M BSS	2	M8 x 20mm BUTTON HEAD SET SCREW	
13	WSSEZ 516	2	5/16" TOOTH LOCK WASHER	
14	TS533A	4	SPACER Ø22.2 x 12.6mm	
15	TS371	4	M10 UNDERFLOOR PLATE 95 X 40	
16	-	1	OEM TOYOTA HIACE HANDLE (NOT SUPPLIED)	

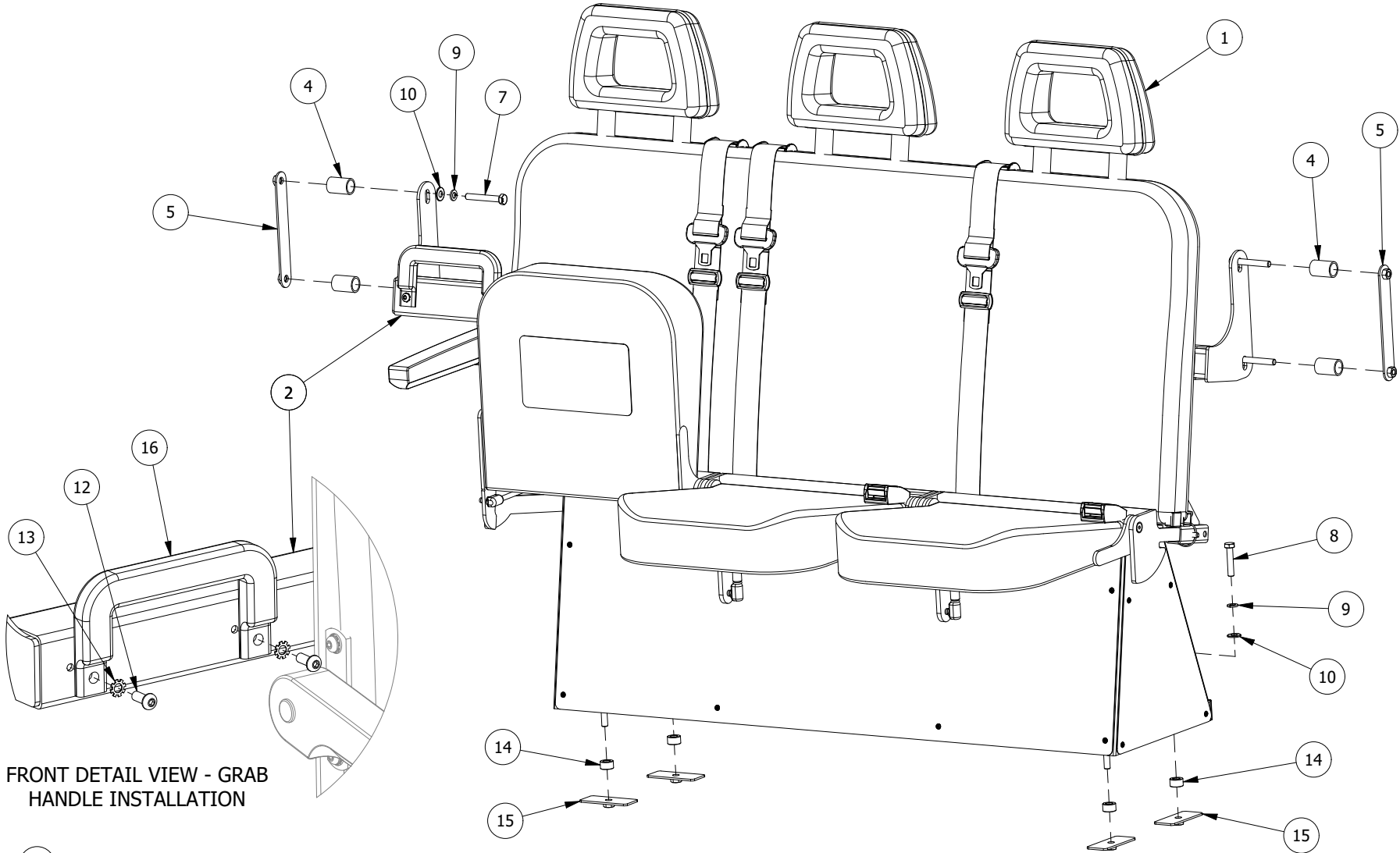

FRONT DETAIL VIEW - GRAB
HANDLE INSTALLATION

REAR VIEW - SUPPORT BEAM INSTALLATION

INSTALLATION NOTES:

1. Remove OEM handrail. Pull back passenger side plastic trim and remove trim locating clips.
2. Pilot drill through from inside, using clip holes as location guides.
3. Holesaw clearance hole using pilot holes as locators.
4. Drill out clip holes to 11mm.
5. Pull back driver side trim and repeat drilling process, as per passenger side.
6. Bolt driver side of cross bar into place first. The backing plate is inserted into position through the cutout at the bottom of the B-pillar.
7. Remove electrical contact in sliding door. The passenger side backing plate is inserted into position through this B-pillar hole.
8. Bolt the rest of the cross beam into position. After torqueing all mounting bolts, site drill for the M10x90mm bolt to join the 2 halves.
10. Position the seat assembly approximately 40mm from the vehicle wall to edge of the seat base foam. Tighten the mounting clamps.
11. Drill 4 x holes in the vehicle floor, using seat frame as a guide and secure using the supplied bolts and plates. Tighten bolts to 32ft.lb / 44Nm using a torque wrench.
12. Reattach the OEM handrail (removed at step 1) to the support beam near the sliding door using the supplied bolts.

BOLT SIZE AND GRADE	ASSEMBLY TORQUE
M10 - Class 8.8	32ft.lb / 44Nm

IMPORTANT INFORMATION FOR INSTALLERS

Aftermarket seats and swivels sold by Techsafe Seating have been tested by an approved testing authority in Australia and found to meet the strength and performance requirements of the appropriate standards. Aftermarket seats and swivels should only be installed by competent and experienced personnel. Aftermarket seats and swivels in some state jurisdictions may require certification by a qualified certifying engineer. In all instances professional engineering advice should be sought to ensure the suitability of the integration of the seat or swivel into the original vehicle structure and to consider for any effect the modification may have on that vehicles compliance with legislated standards. As the manufacturer and seller of this product has no control over the end use or the fitment to the vehicle, the manufacturer and seller accepts no responsibility or liability for any malfunction of the product or the vehicle occupant safety systems as a direct or indirect result of faulty installation or unauthorized repair or modification to this product. Modification of the seat, swivel or installation kit should not be made without certification by a qualified engineer or manufacturers written consent. Where components of the installation kit are modified to better suit the specific nature of the installation, these must be substituted with components of equivalent or greater strength. Good engineering practice should be evident at all times including the use of metal spacers between brackets and the floor pan, appropriately torqued anchorage bolts, rust inhibitors on drilled holes and adhesive sealant used on underfloor backing plates.

PROPRIETARY AND CONFIDENTIAL

THE INFORMATION CONTAINED IN THIS DRAWING IS THE SOLE PROPERTY OF TECHSAFE. ANY REPRODUCTION IN PART OR AS A WHOLE WITHOUT THE WRITTEN PERMISSION OF TECHSAFE IS PROHIBITED.



56 Lower Mountain Road
HERVEY BAY QLD 4655
PH 07 4128 3337
email: technical@techsafeseating.com.au
web: techsafeseating.com.au

PRODUCT **TRIPLE REVERSE FACING FLIP-UP**

VEHICLE/PROJECT
**TOYOTA HIACE COMMUTER H300 SLWB
PEOPLE MOVER 05/2019 ON**

DESIGN APPROVAL No. 20200022L001Rev1	COMPLIES WITH VSB 5 (3.0 - Rev. 1)	REV 1
DATE 3/08/2021	DWG No. PK160	