

ITEM NO.	PART NO.	QTY.	DESCRIPTION	PACKED BY
1	TSA1126	1	FRONT CENTRE SEAT ASSEMBLY	
2	10X75M 88 ZPB	2	M10 x 75mm HEX BOLT	
3	10X65M 88 ZPSS	2	M10 x 65mm HEX HEAD SET SCREW	
4	10M SW	4	M10 SPRING WASHER	
5	10M ZPW	4	M10 FLAT WASHER	
6	TS917	2	SPACER Ø26.7 x 23mm	
7	TS1019	2	SPACER Ø26.7 x 33mm	
8	TS371	3	M10 UNDERFLOOR PLATE 95 x 40	
9	TS371-S	1	M10 UNDERFLOOR PLATE 70 x 40	
10	-	1	FITTING INSTRUCTIONS - WITHIN THIS PACKING KIT	

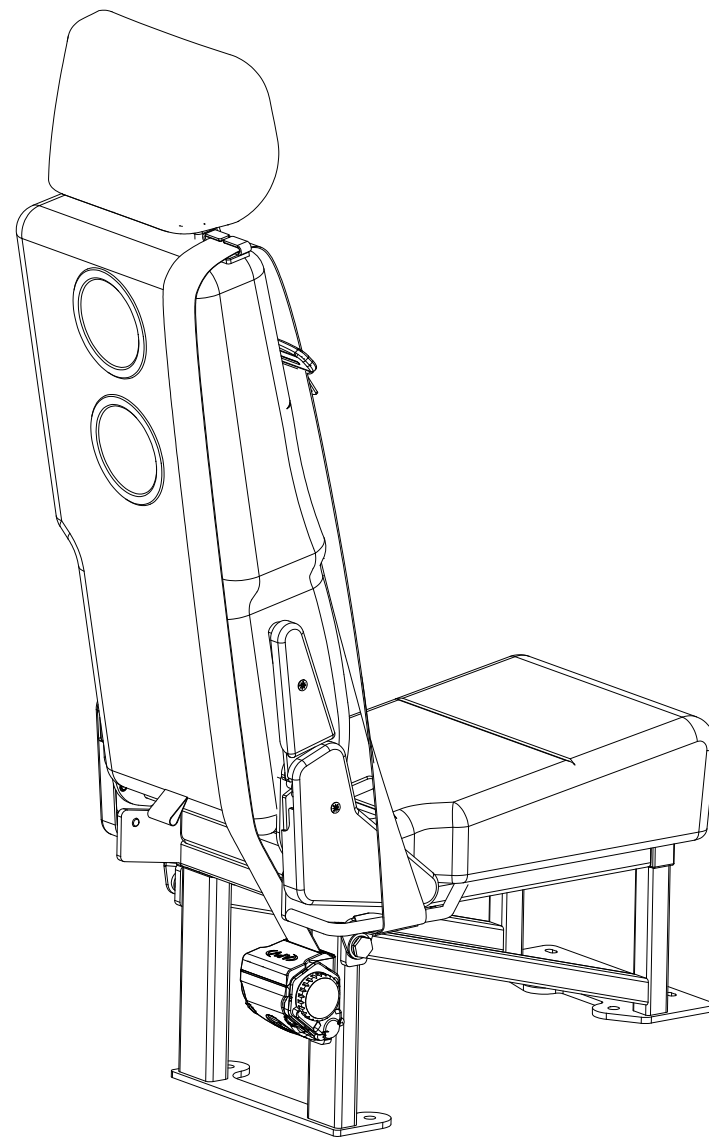

**FIGURE 1
SEAT INSTALLATION**

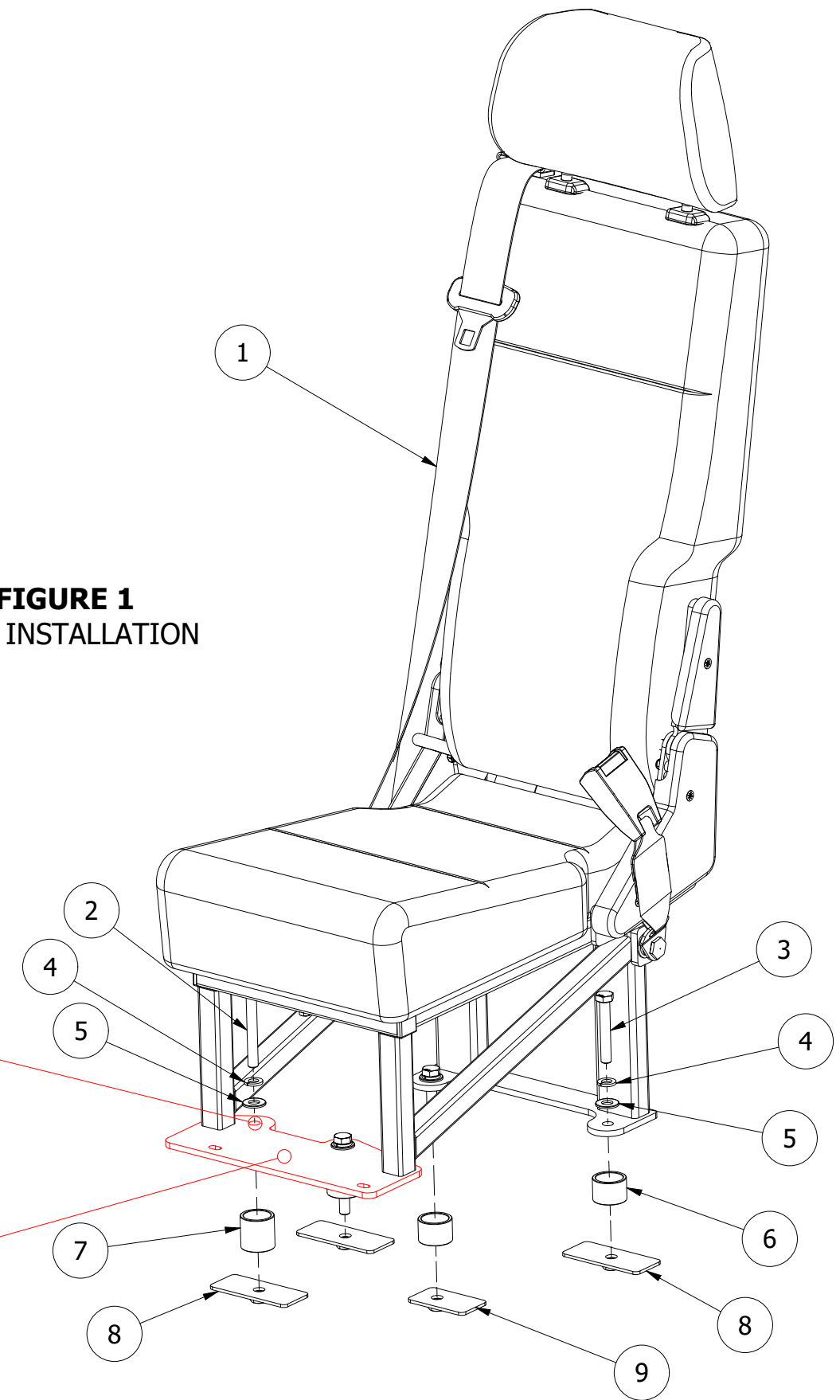

NOTE: Electrical wires in close proximity to driver side front mount hole.

Move wires aside before drilling through floor foam with hole saw.

NOTE: Ensure that fuel door release cable/mechanism is not pinched under front floor plate of seat during install.

IMPORTANT INFORMATION FOR INSTALLERS

Aftermarket seats and swivels sold by Techsafe Seating have been tested by an approved testing authority in Australia and found to meet the strength and performance requirements of the appropriate standards. Aftermarket seats and swivels should only be installed by competent and experienced personnel. Aftermarket seats and swivels in some state jurisdictions may require certification by a qualified certifying engineer. In all instances professional engineering advice should be sought to ensure the suitability of the integration of the seat or swivel into the original vehicle structure and to consider for any effect the modification may have on that vehicles compliance with legislated standards. As the manufacturer and seller of this product has no control over the end use or the fitment to the vehicle, the manufacturer and seller accepts no responsibility or liability for any malfunction of the product or the vehicle occupant safety systems as a direct or indirect result of faulty installation or unauthorized repair or modification to this product. Modification of the seat, swivel or installation kit should not be made without certification by a qualified engineer or manufacturers written consent. Where components of the installation kit are modified to better suit the specific nature of the installation, these must be substituted with components of equivalent or greater strength. Good engineering practice should be evident at all times including the use of metal spacers between brackets and the floor pan, appropriately torqued anchorage bolts, rust inhibitors on drilled holes and adhesive sealant used on underfloor backing plates.

PROPRIETARY AND CONFIDENTIAL

THE INFORMATION CONTAINED IN THIS DRAWING IS THE SOLE PROPERTY OF TECHSAFE. ANY REPRODUCTION IN PART OR AS A WHOLE WITHOUT THE WRITTEN PERMISSION OF TECHSAFE IS PROHIBITED.



56 Lower Mountain Road
HERVEY BAY QLD 4655
PH 07 4128 3337
email: technical@techsafeseating.com.au
web: techsafeseating.com.au

PRODUCT FRONT CENTRE SEAT

VEHICLE/PROJECT
**TOYOTA HIACE H300 VAN 05/2019 ON
(VARIANTS WITHOUT CENTRE CONSOLE)**

DESIGN APPROVAL No. LK2 1093165	COMPLIES WITH VSB 5 (3 - Rev. 1) CAT 1	REV 3
DATE 30/07/2021	DWG No. PK152	

FITTING INSTRUCTIONS

STEP 1 - SEAT POSITIONING

Using **Figure 2** as a guide, run a straight edge (**30mm min. thickness** to ensure contact across faces of seat base plastics) across the front of both the driver and passenger seat bases where they meet the floor.

Next, position the seat so the measurement from the straight edge, to the very front edge of the front floor plate is **71mm** (as per **Figure 2**).

The seat must also be moved as far towards the passenger side as possible, to allow sufficient room for the hand brake.

STEP 2 - SEAT INSTALL

Once the seat is in position, mark the 4 x M10 floor bolt locations. Remove the foam from these 4 bolt locations using a 27mm hole saw. Once the foam has been removed, **drill the 4 marked holes to approx. 10.5mm** to allow fitment of the 4 x M10 bolts.

Note: When using the hole saw to remove the floor foam, take care not to damage/cut into the metal vehicle floor.

The 4 x M10 bolts, washers, spacers and floor plates can be fitted, as per **Figure 1** on **Page 1**. Once the underfloor plates are positioned and aligned correctly, tighten the M10 bolts to **32ft.lb / 44Nm**.

FIGURE 2
SEAT POSITIONING

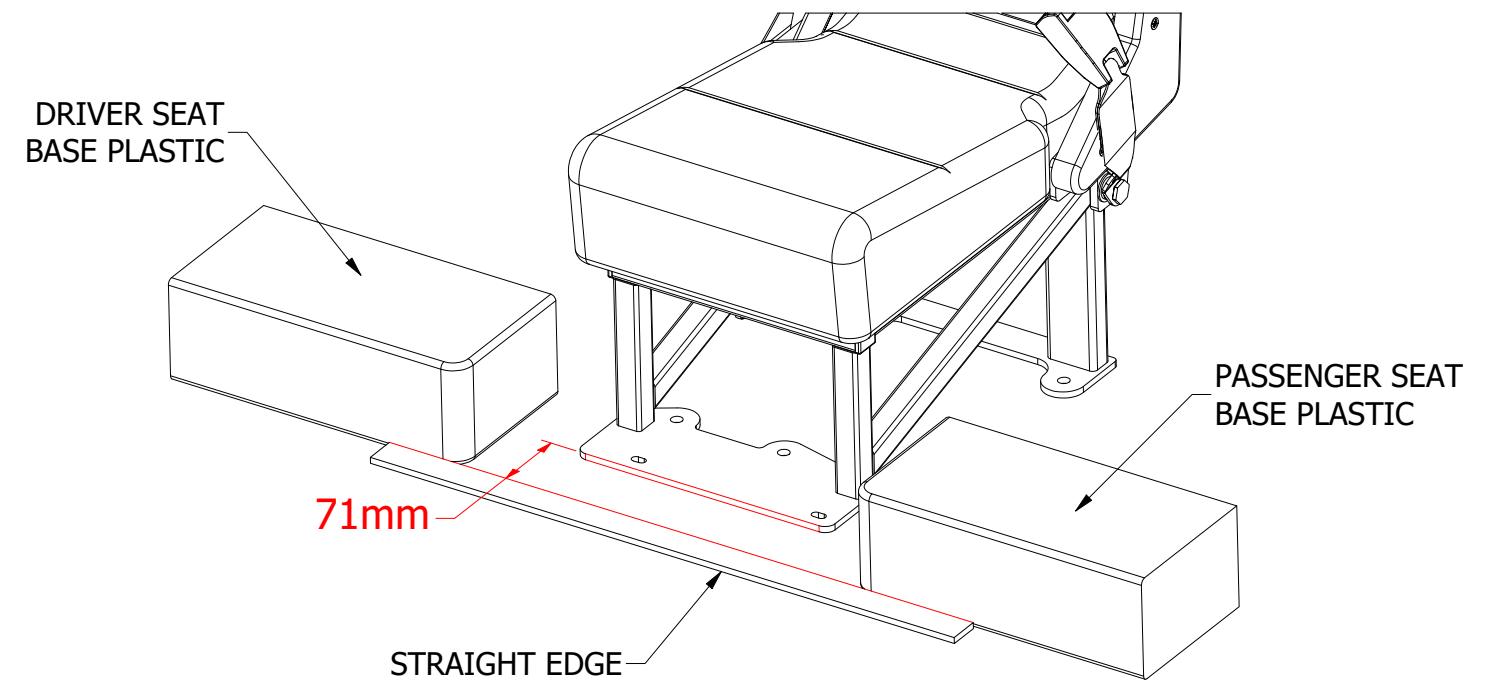
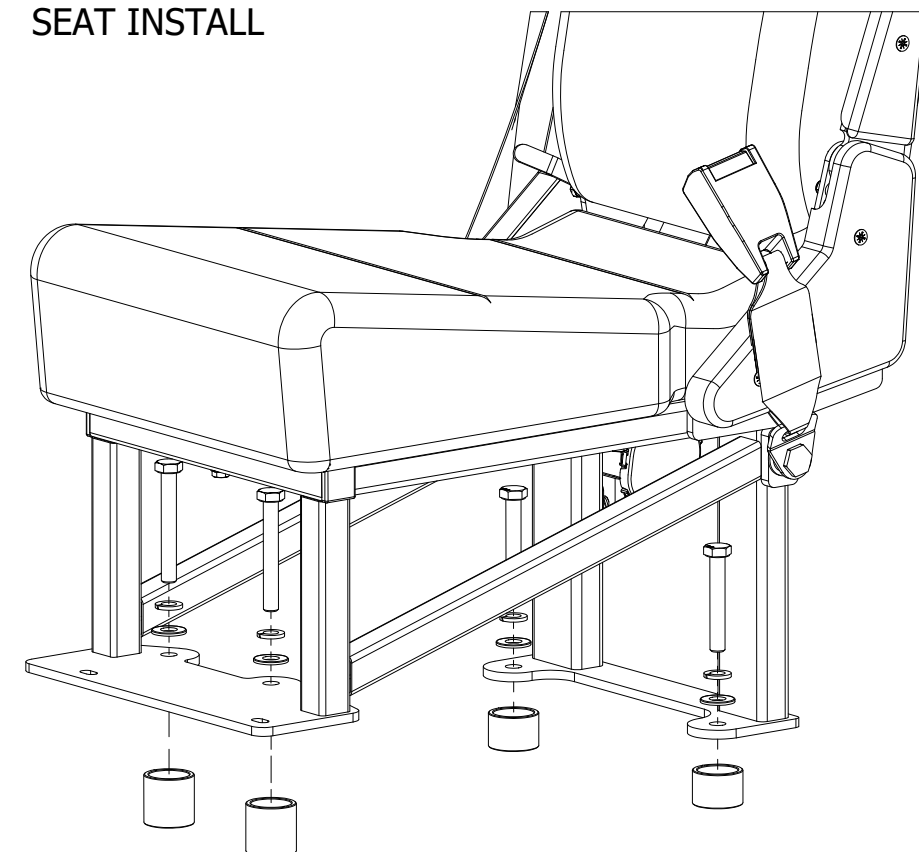

FIGURE 3
SEAT INSTALL



STEP 3 - PASSENGER SEAT RAIL TAB

In order for the subject seat to be compliant with the dimensional requirements of ADR 5/06 and VSB 5, the 1st row passenger seat must be permanently locked into its rear-most position such that the combination of the centre seat and OEM 1st row passenger seat create a 2-occupant bench seat arrangement, with a combined cushion width of 820mm.

The 1st row passenger seat should be permanently locked into its rear-most position by folding in the metal tab on outboard seat slide rail, as shown in **Figure 4**.

FIGURE 4
PASSENGER SEAT RAIL TAB

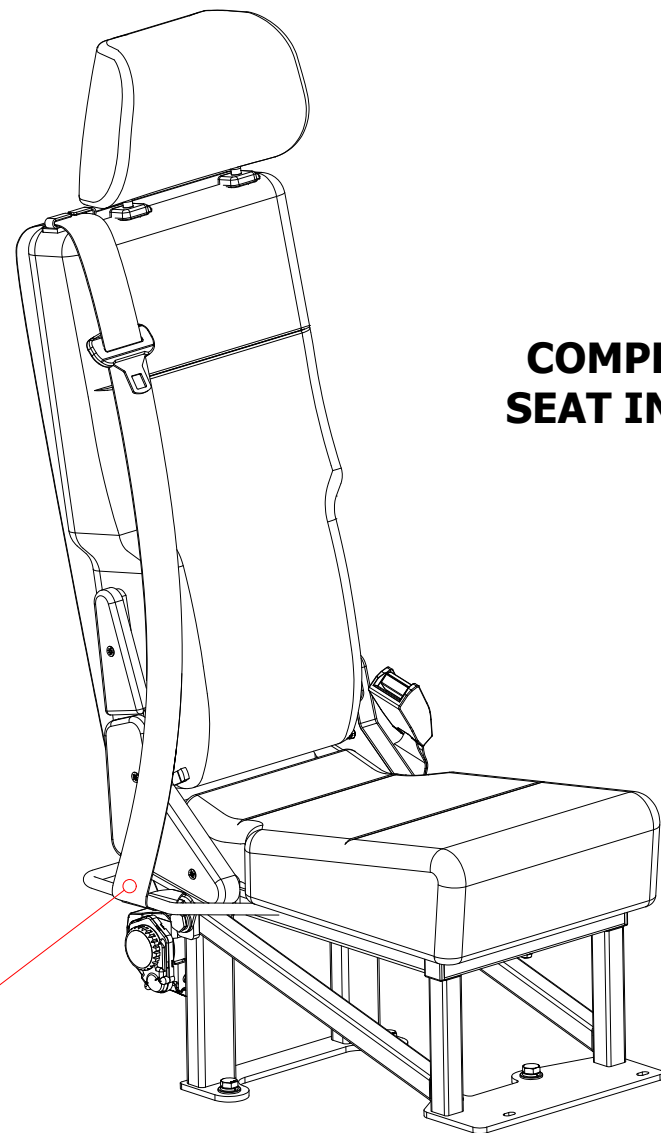
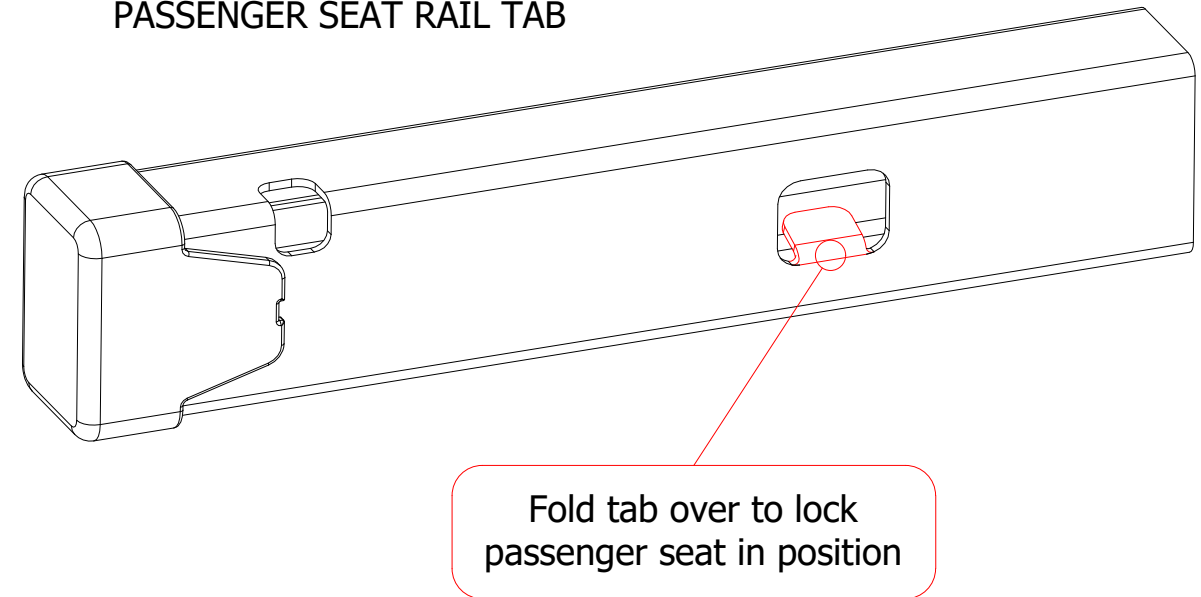

COMPLETED SEAT INSTALL

IMPORTANT NOTE: ANCAP SAFETY RATING

It should be noted that any modifications to a vehicle, including the fitment of additional equipment or seating within a vehicle cabin, has the potential to affect any ANCAP safety rating, or similar, that has been claimed by a vehicle manufacturer. This rating is purely for consumer information and allows for comparison of vehicle safety performance under prescribed test conditions. It is not a mandatory safety standard required for homologation and supply to market. Vehicle owners and operators will need to make their own assessment in this regard with respect to their fleet safety requirements.